

JACKSON OVEN SUPPLY, INC.

Jackson Oven batch ovens are user friendly and safe for the environment. Temperatures available 500F, 650F & 750.

TYPICAL APPLICATIONS

JOS batch ovens are designed for:

- Baking
- Drying
- Preheating
- Annealing
- Out Gasing
- Heat Treating
- Curing
- Stress Relieving

“Hi-velocity ovens available upon request, ask your representative”



- Recirculating blower air flow switch
- Electronic flame supervision safeguard
- Purge timer
- Exhaust fan for exhausting volatiles
- Exhaust fan air flow switch
- Pilot safety shutoff valve(s)
- Main gas safety shutoff valve(s)
- High gas pressure switch
- Low gas pressure switch

CONSTRUCTION

- Choice of air flow patterns
- Adjustable louvers
- Aluminized steel interior
- Steel Plate Floor
- Heavy duty structural door(s)

“Factory test fired prior to shipment”

STANDARD FEATURES

CONTROLS

- Analog temperature control
- Modulating burner on gas ovens
- Motor control push buttons

ELECTRIC OVEN SAFETY COMPONENTS

- Excess temperature control, adjustable
- Recirculating blower air pressure switch
- Independent contactors for heating elements

GAS OVEN SAFETY COMPONENTS

- Excess temperature control, adjustable

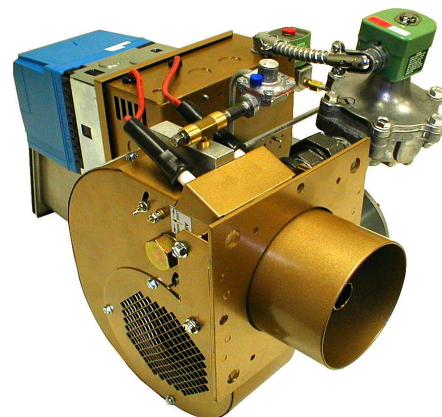

Gas Oven Burner with
Electronic Flame Supervision Safeguard

IMPORTANT

If flammable solvents or vapors are present in a Batch Oven, OSHA requires conformance with NFPA 86 which defines Batch Ovens for these applications as Class A ovens. A powered forced exhauster and other non-standard safety equipment must be added. Speak with your representative for clarification and direction.

OPTIONS AVAILABLE

Exhaust Fan	Voltage Transformer
SCR	Variable Frequency Drive
Batch Timer	Programmable Temperature Controller
Shutdown Timer	Afterburner
Temperature Recorder	Cart
Exhaust Stack	Door Limit Switch (low heat condition)

APPLICABLE CODES

NFPA86
Industrial Risk Insurers
Factory Mutual
OSHA

OPTIONAL AFTERBURNER

An afterburner is available for those customers whose process emits small amounts of smoke, odor and (or) particulate. The fumes from the oven are vented through an afterburner chamber which raises the fume temperatures to 1400 F and higher for a minimum of ½ second. The resultant effluent discharged to atmosphere consists of water vapor (H₂O) and carbon dioxide (CO₂). Afterburner includes high temperature stack, roof flashing, and weather collar and rain cap. JOS will assist with the environmental permitting process.



OPTIONAL PROGRAMMABLE TEMPERATURE CONTROLLER

The MIC 6000 is a 1/4 DIN, microprocessor based, single loop, profiling, process controller. It can function either as a basic process controller, utilizing manual set-point changes or it can also execute any one of eight set-point profiles; each profile can have six ramp and six soak segments.

Using the instrument's security-access mode may restrict access to configuration parameters and set-point.

OPTIONAL TEMPERATURE RECORDER

Designed with the latest innovations in recording technology, enclosures and functionality, the MRC 5000 is slim, trim and simple. The MRC 5000 is a digital circle chart recorder capable of measuring, recording and controlling (optional) up to two process variables from a variety of inputs.



JACKSON OVEN SUPPLY, INC.

Industrial Ovens · Parts · Service

3507 Wayland Dr · Jackson · MI · 49202 · Phone 517-784-9660 · Fax 517-784-9670

www.jacksonoven.com

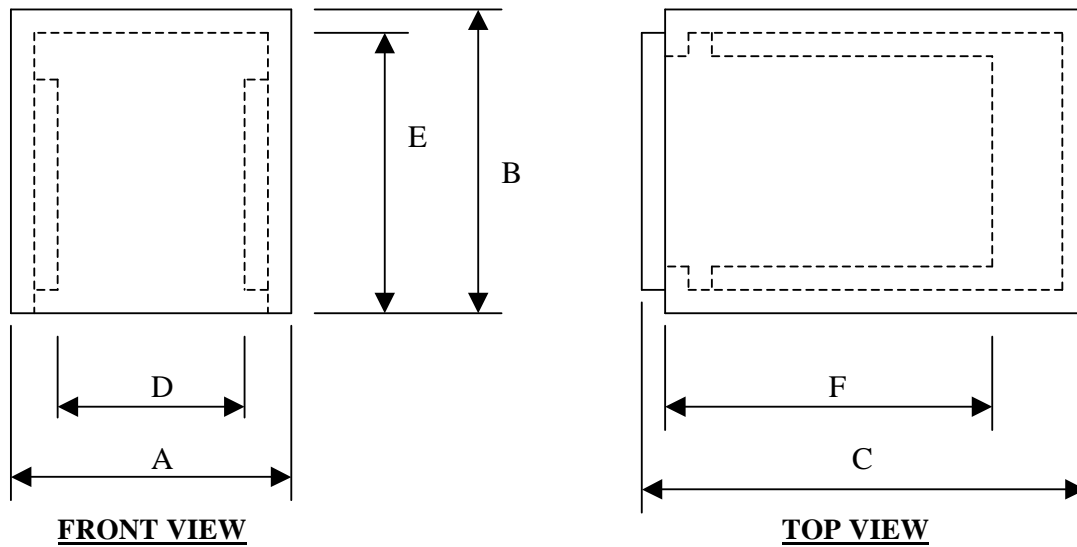

THIS IS A SMALL CROSS SECTION OF SIZES AVAILABLE, CONTACT JACKSON OVEN FOR OTHER SIZES

SPECIFICATIONS 500F											
MODEL NO	NOMINAL EXTERNAL DIMENSIONS (INCHES)			NOMINAL INTERNAL DIMENSIONS (INCHES)			HEATER		RISE TIME MINUTES		APPROX. WEIGHT POUNDS
	A WIDTH	B HEIGHT	C DEPTH	D WIDTH	E HEIGHT	F DEPTH	KW	BTU/HR	ELECT	GAS	
3303	50	40	68	36	36	36	10	125,000	25	10	2,200
3403	50	52	68	36	48	36	12	150,000	30	15	2,500
4404	62	52	80	48	48	48	14	175,000	30	15	2,800
4504	62	64	80	48	60	48	18	175,000	30	15	2,900
4604	62	76	80	48	72	48	22	250,000	40	20	3,000
5505	74	64	92	60	60	60	24	250,000	40	20	3,400
4606	62	76	106	48	72	72	26	300,000	40	40	3,600
5605	74	76	92	60	72	60	26	300,000	40	20	3,800
5606	74	76	104	60	72	72	26	300,000	40	20	4,000
6606	86	76	104	72	72	72	28	350,000	40	25	4,100
5608	74	76	128	60	72	96	28	350,000	40	25	4,100
7606	98	76	104	84	72	72	28	350,000	40	25	4,300
6608	86	76	128	72	72	96	30	400,000	40	25	6,700
7608	98	76	128	84	72	96	30	400,000	40	25	6,800
6610	86	76	152	72	72	120	36	600,000	30	20	7,600
7610	98	76	152	84	72	120	40	600,000	30	20	8,500

NOTES: All specifications are nominal and subject to change without notice
 All Models—Control panel overhang 12" right side.
 Blower motor overhang 19" rear through 5 HP, 26" up to 10 HP, 30" at 15 HP, and 36" at 20 HP.
 Gas Models—Burner overhang 15" right side

JACKSON OVEN SUPPLY, INC.

Industrial Ovens · Parts · Service

3507 Wayland Dr · Jackson · MI · 49202 · Phone 517-784-9660 · Fax 517-784-9670

www.jacksonoven.com